

John Redman

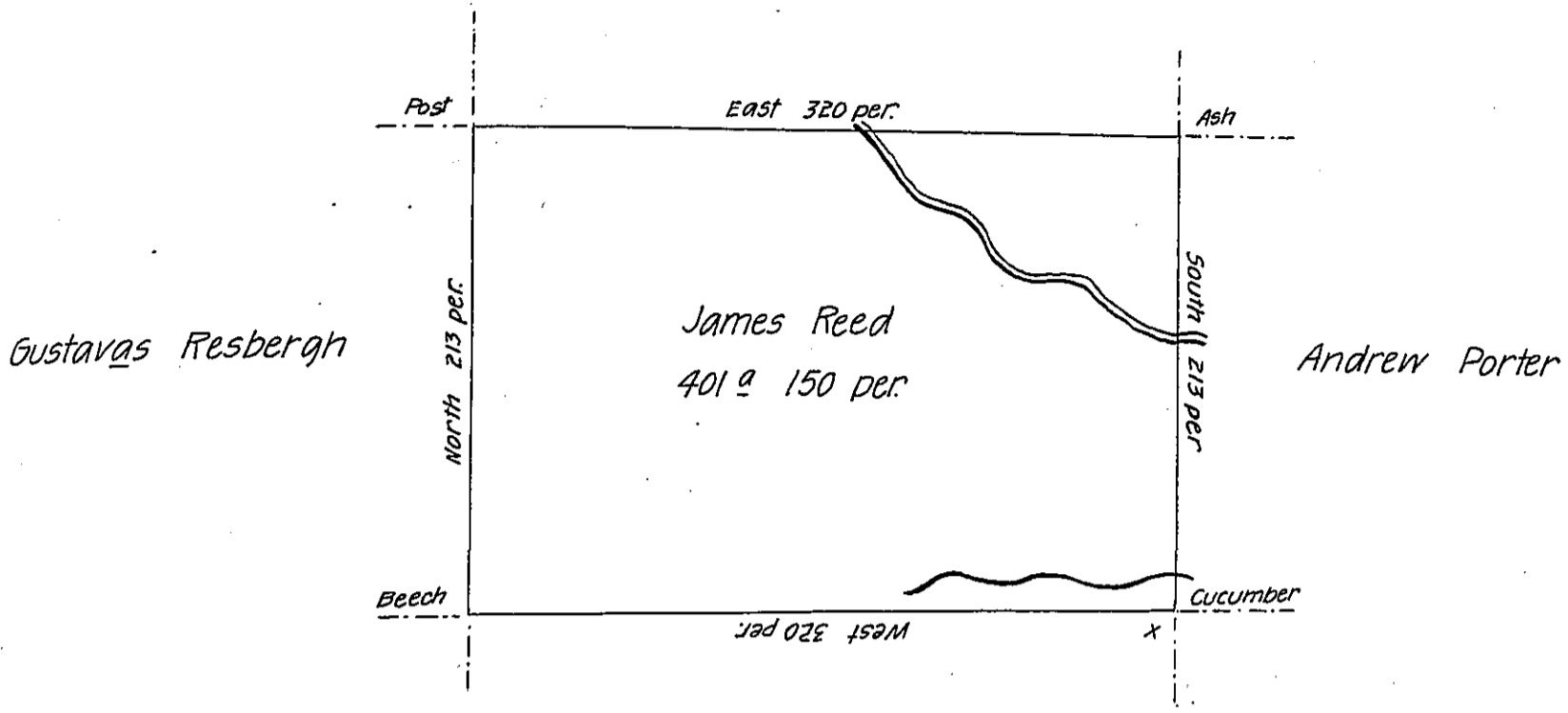

Danl. Rees

Situate on the West side of French Creek Aleghiny County  
 Containing 401 acres 150 perches & allowance of six p. cent for  
 roads &c Surveyed the 14<sup>th</sup> day of May 1795, in pursuance of  
 a warrant dated the 30<sup>th</sup> day of May 1792.

W<sup>m</sup> Power DY SC

To Danl. Brodhead Esq<sup>r</sup>  
 Surveyor General.

IN TESTIMONY that the above is a copy of the original remaining on file in  
 the Department of Internal Affairs of Pennsylvania, made  
 conformably to an Act of Assembly approved the 16th day of  
 February, 1833, I have hereunto set my Hand and caused  
 the Seal of said Department to be affixed at Harrisburg,  
 this twenty third day of June 1906.

*George D. ...*  
 Secretary of Internal Affairs.